



# GeeseMed Refill Request Mgmt Manual-2017



## REFILL REQUEST MANAGEMENT

- Refill Request Management is used to manage and respond to refill requests.
- There are two options to open the Refill Request Mgmt Screen:
  1. Path: **“Patient Hub>>Medication/RX>>Refill Request Mgmt.”**

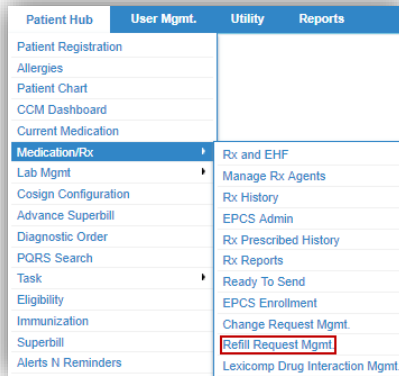

2. Path: **“Provider Hub>>Home>>Refill Requests”**

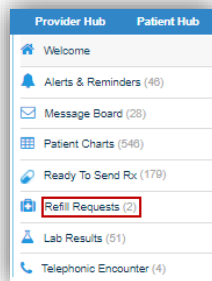

- Clicking the Refill Request Mgmt opens the screen below.

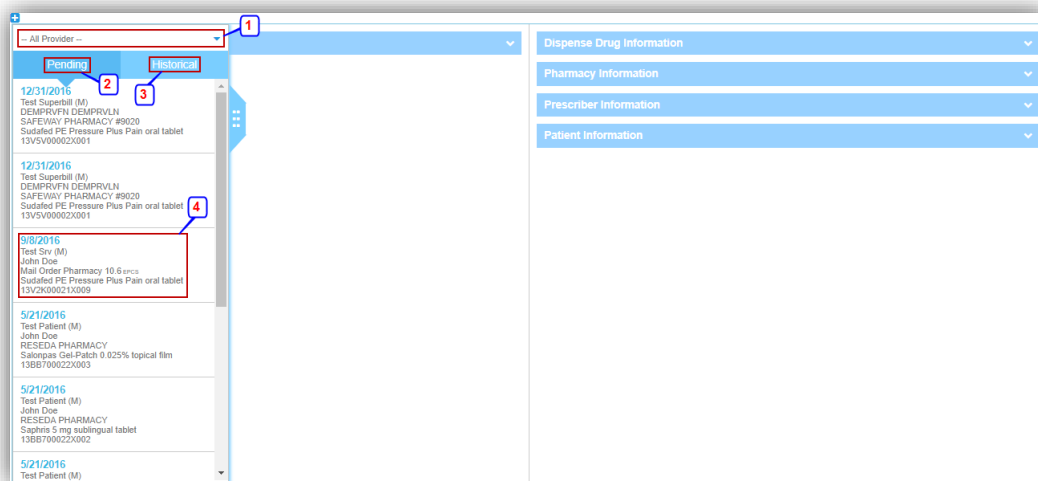

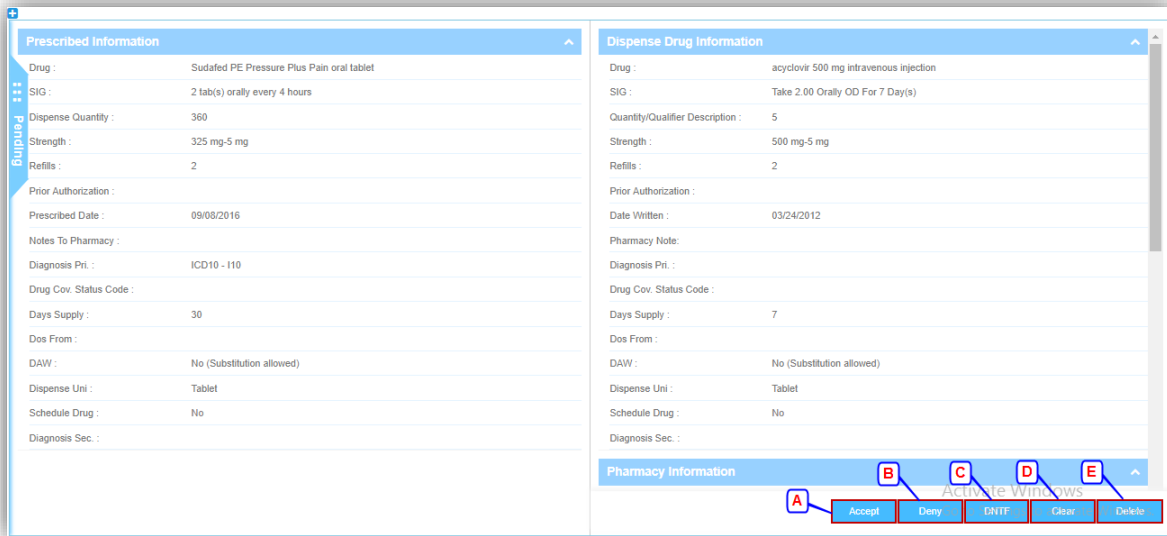

A. To refill the request, click on **'Accept'**. Open detail screen shown below:

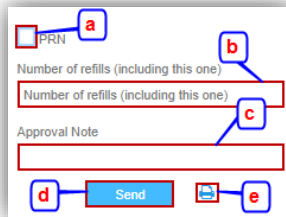

- a. Click the checkbox for PRN.
- b. Enter the number if Refills.
- c. Enter Approval Note if needed.
- d. Click on **'Send'** to send the Refill.
- e. Click on to print the original RX.
- B. Click on **'Deny'** to deny and enter the details for denial.
- C. Click on **'DNTF'** to deny with new RX to follow.
- D. Click on **'Clear'** to clear the details.
- E. Click on **'Delete'** to delete selected refills.

## Version Change Log

Version	Date	Updated By	Approved By	Change Details
V6.0.11	08/14/2017	Gary	Marc - 09/27/17	-